

AVIAID

COMPETITION OIL PANS



WET SUMP & DRY SUMP Vintage & Contemporary Applications



AVIAID COMPETITION OILING SYSTEMS
 10041 Canoga Ave., Chatsworth, CA 91311 • Phone: 818-998-8991 • Fax: 818-998-8993
 E-mail: aviaid@aol.com Website: www.aviaid.com



#55355 302 SB Ford Wet Sump Pan (original 289 Cobra)
 #55356 351 SBW Ford Wet Sump Pan (original 289 Cobra)

← Front View



#55350 302 SB Ford 7.5: Wet Sump Pan (original GT 350 "R" model)
 #55351 351 SBW Ford 7.5: Wet Sump Pan (original GT 350 "R" model)

← Front View

BIG BLOCK FORD



#52412 Ford FE 3 pick-up Dry Sump Pan (right side outlet)

← Front View



#55410 Ford FE Wet Sump Pan (original 427 Cobra)
 #55412 Ford FE Wet Sump Pan (front sump Mustang)

← Front View



#52400 460 Ford 3 pick-up Dry Sump Pan

← Front View



#55435 460 Ford Wet Sump Pan (427 Cobra style)

← Front View



#55365 351C SB Ford (Cleveland) Wet Sump Pan (original design-Pantera)
 #55432 460 Ford Wet Sump Pan (Pantera)

← Front View

JAVELIN



#55700 AMC 360/401 Wet Sump Pump (Javelin Trans Am)
 #109-24050 AMC External Pickup Pump Adapter Plate
 #159-59906 Add External Pickup - Wet Sump Pan

← Front View

SMALL BLOCK CHEVY



- #52100 Small Block Chevy 2 pick-up Dry Sump (right side outlet)
- #52101 Small Block Chevy 2 pick-up Dry Sump (std. left side outlet)
- #52110 Small Block Chevy 2 pick-up Dry Sump (w/1" kick-out, right outlet)
- #52120 Small Block Chevy 2 pick-up Dry Sump (w/1" kick-out, left outlet)

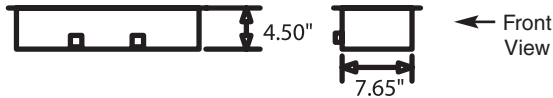

- #55112 Small Block Chevy 8" Wet Sump (Trans Am Camaro)
- #55120 Small Block Chevy 7-1/4" Wet Sump (B/P Corvette road race)
- #55122 Small Block Chevy 8" Wet Sump (B/P Corvette road race)

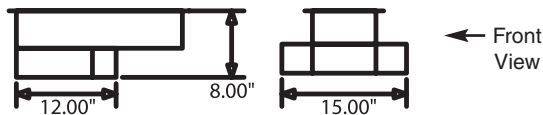

- #52130 Small Block Chevy 3 pick-up Dry Sump Pan (All Pro-Modified)

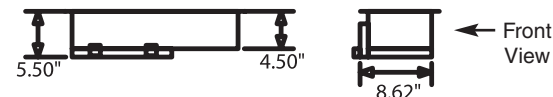

NOT SHOWN

- #58140 SBC Dry Sump (Crackerbox)

BIG BLOCK CHEVY



- #58240 Big Block Chevy 3 pick-up Dry Sump Pan - Marine (Hydro)

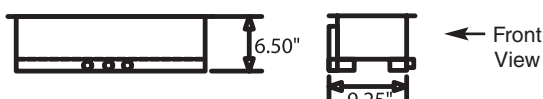

- #52200 Big Block Chevy 3 pick-up Dry Sump (right side outlets)

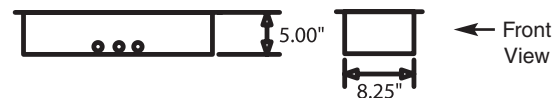

- #52201 Big Block Chevy 3 pick-up Dry Sump (left side outlets)

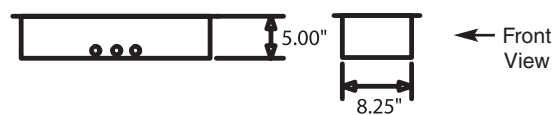

- #52210 Big Block Chevy 3 pick-up Dry Sump (std. left side outlet)



- #57242 Big Block Chevy wet sump (Off-Shore Marine)

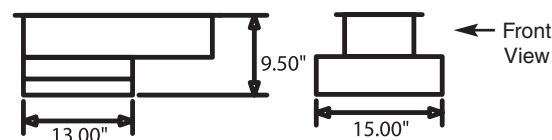

SMALL BLOCK FORD



- #52310 302 SB Ford 2 pick-up Dry Sump Pan (right side outlet)
- #52320 351W SB Ford 3 pick-up Dry Sump Pan (right side outlet)

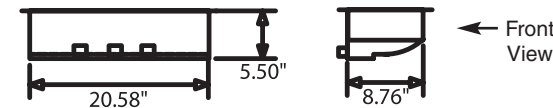

- #55301 302 SB Ford dual sump 5.0 Mustang Wet Sump (road race)
- #55310 351W SB Ford dual sump 5.0 Mustang Wet Sump (road race)

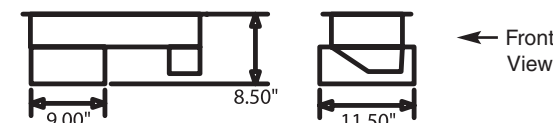

- #55366 302 SB Ford Wet Sump Pan (Mangusta)
- #55367 351W SB Ford Wet Sump Pan (Pantera)

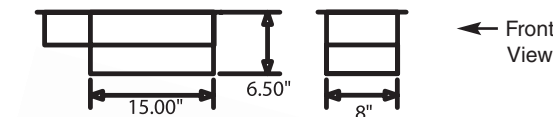

- #55326 302 SB Ford 8.5" Wet Sump Pan (Holman/Moody style)
- #55328 351W SB Ford 8.5" Wet Sump Pan (Holman/Moody style)
- #55354 302 SB Ford 8.5" Wet Sump Pan (Bud Moore style)
- #55323 351W SB Ford 8.5" Wet Sump Pan (Bud Moore style)

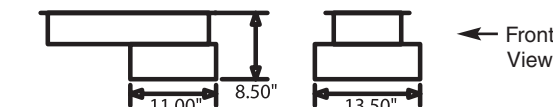

- #55320 302 SB Ford 7.5" Wet Sump Pan (standard early Mustang)
- #55325 351W SB Ford 7.5" Wet Sump Pan (standard early Mustang)

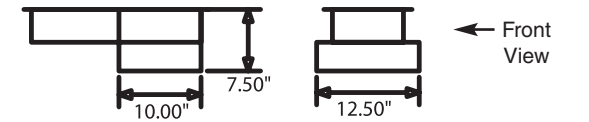

- #55335 302 SB Ford 9.5" Wet Sump Pan (w/skid plate)
- #55340 351 SB Ford 9.5" Wet Sump Pan (w/skid plate)

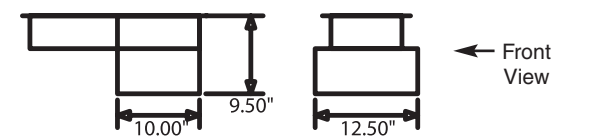

- #55360 302 SB Ford Wet Sump Pan (original GT40, w/starter notch)
- #55361 351W SB Ford Wet Sump Pan (original GT40, w/starter notch)
- #55362 302 SB Ford Wet Sump Pan (original Daytona Coupe)
- #55363 351W SB Ford Wet Sump Pan (original Daytona Coupe)



- #55370 Small Block Ford Wet Sump (Sunbeam Tiger)

